



AN112/120

Programmable Alarm Annunciator

The AN112/120 series Alarm Annunciator provides ideal solution for all your alarm system management and requirement. It comes with either 12 or 20 windows, and due to the use of microprocessor-based design, the alarm annunciator is highly flexible in terms of functionality and programmability, suitable for all application and industries.

Features

- 12 or 20 windows. Replaceable super-bright LED modules, with choice of amber or red illumination
- 11 Alarm Sequences as per ISA-18.1 standard
- Each channel/window fully field programmable, either from front panel built-in pushbutton or using PC
- Option of either RS232 or RS485 MODBUS-RTU communication. Comes with user-friendly configuration software.
- Repeat relay for each window as well as numerous configurable multifunction output relays for connection to external equipment to form alarm management system
- Sleep or unattended mode feature is available, for stations not permanently manned
- Auto-silence and auto-acknowledge features, with delay settable from 1 – 255 s

TYPICAL CONNECTION DIAGRAM

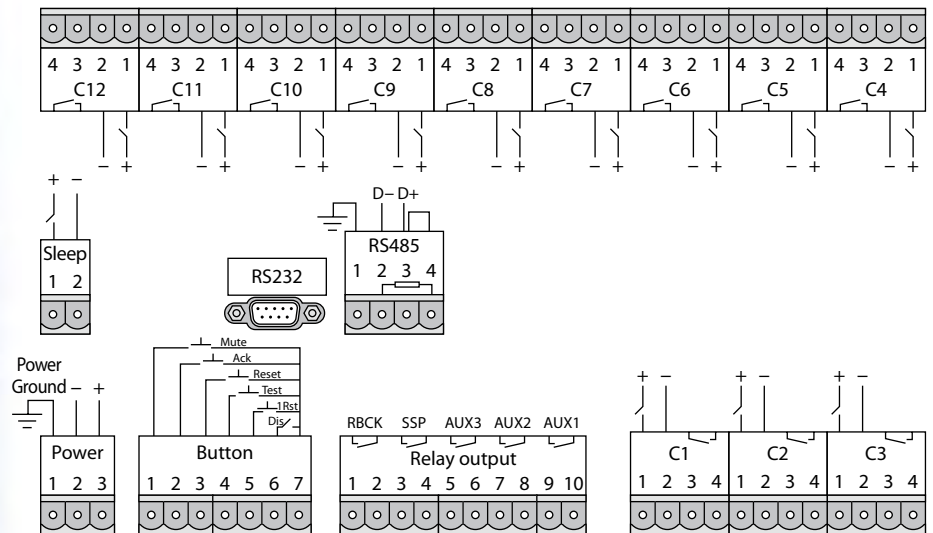

Tests And Standards

- Electrostatic discharge IEC61000-4-2, Class III, air discharge 8 KV
- Electrostatic discharge IEC61000-4-2, Class III, contact discharge 6 KV
- Electrical fast transient IEC61000-4-4 4 KV, 5/50ns
- Surge immunity IEC61000-4-5 4 KV, L to E
- Enclosure protection when panel mounted Front: IP41
..... Enclosure: IP30

Technical Data

WINDOW

Window Dimension:	50 x 30 mm.
Type:	White translucent lens.
Colours:	Red, Amber. Coloured by field replaceable LED module.
Windows Flash	Fast: 1.4 Hz (0.4s on, 0.4s off), Slow: 0.45 Hz (1.1s on, 1.1s off), Intermittent: (0.4s on, 1.8s off)

ALARM SEQUENCES	M, A, R, R-12, F1A, F1M, F2A, F2M, F3A, F3M, Follower
------------------------	---

TYPE OF MOUNTING	Panel Mounting
-------------------------	----------------

AUXILIARY POWER INPUT

Fuse protected.	
AN1xx-30	24-36 V DC or 18-27 V AC.
AN1xx-110	88-132 V DC or 64-95 V AC.
Power consumption	AN112: 6 W, AN120: 8 W

ALARM CONTACT INPUTS

Opto-isolated inputs	
AN1xx-30	24-36 V DC or 18-27 V AC.
AN1xx-110	88-132 V DC or 64-95 V AC.
Input current	3 mA typical

RELAY OUTPUTS

Repeat relays	Potential free for each alarm point. 5 A at 250 V AC, 3 A at 30 V DC. Resistive load.
AUX1-AUX3, RBACK, SSP	5 A at 250 V AC, 5 A at 30 V DC. Resistive load.

TERMINALS

Wire size	28-14 AWG. (0.08mm ² to 2.5mm ²) Removable screw type terminal block (removable)
-----------	---

ENVIRONMENT

Operation temperature	-20 to 60°C
Storage temperature	-20 to 80°C
Humidity	0 - 95% RH, non condensing

COMMUNICATION

Hardware interface	AN1xx - xx - x - A: RS232 AN1xx - xx - x - B: Isolated RS485
Protocol	Modbus - RTU
Baud rate	300 to 57600

ENVIRONMENTAL CONDITIONS

Temperature	: -5°C to +55°C
Humidity	: 56 days at 93% RH and 40°C non-condensing

CASE DIMENSIONS

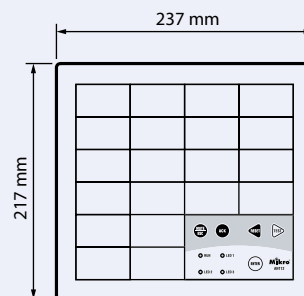

AN120 Front

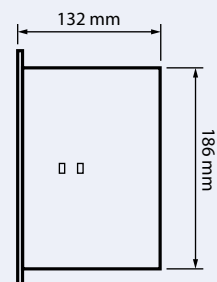

AN120 Side

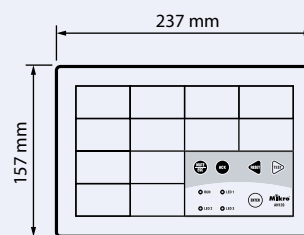

AN112 Front

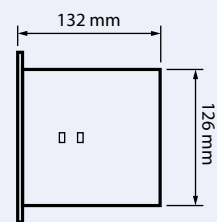

AN112 Side

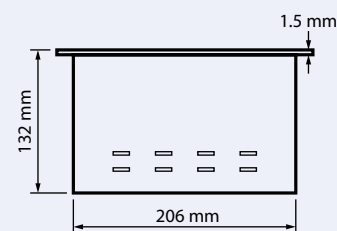

Bottom

Ordering Information

Order code:	
AN1 [] - [] - [] - []	A: RS 232 communication B: RS 485 communication
	0: without repeat relays 1: with repeat relays
	Power Supply: 30, 110 V DC
	Number of Windows: 12, 20

For example: 12 windows, 30 V DC, with repeat relays, RS232 communication:
AN112-30-1-A